

THR-Variant

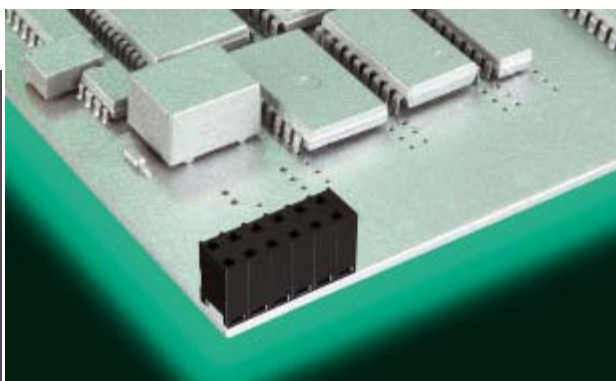



AK 4400/.. - 3,5 - V - black - HT

2-16 poles, Spacing 3,5 mm
insert required no. of poles ..

How to order see page 11

Ratings:

	*approval pending	
	* 	* 
Rated Voltage	150 V	130 V
Rated Current	4 A	4 A (T60)
Wire Size	AWG 22-20 s	0,5 mm ² s
Test Voltage		1,25 kV

Max. Rated Cross Section

Single Wire (solid) 0,5 mm²

Dimensions

Spacing 3,5 mm
Stripped Length 5,5 mm

Materials

Insulating Material LCP
Flammability Class UL94 V-0
Temperature Range -30°C/+105°C
Tension Spring stainless steel
Contact stainless steel

Colour

black

AK 4400 VERTICAL

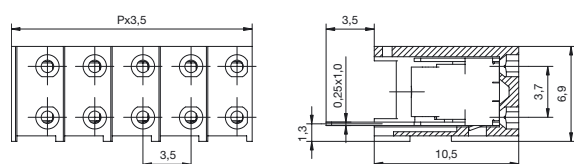

P = No. of poles

THR-Variant





AK 4400/.. - 3,5 - H - black - HT

2-16 poles, Spacing 3,5 mm
insert required no. of poles ..

How to order see page 11

Ratings:

	*approval pending	
	* 	* 
Rated Voltage	150 V	130 V
Rated Current	4 A	4 A (T60)
Wire Size	AWG 22-20 s	0,5 mm ² s
Test Voltage		1,25 kV

Max. Rated Cross Section

Single Wire (solid) 0,5 mm²

Dimensions

Spacing 3,5 mm
Stripped Length 5,5 mm

Materials

Insulating Material LCP
Flammability Class UL94 V-0
Temperature Range -30°C/+105°C
Tension Spring stainless steel
Contact stainless steel

Colour

black

AK 4400 HORIZONTAL

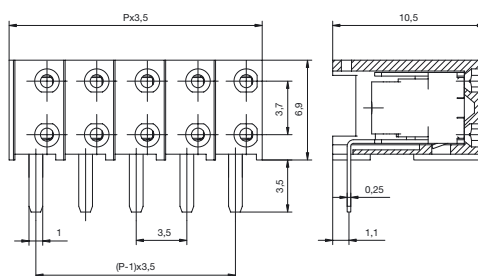

P = No. of poles